

STEEL, VALVE & PIPE FITTING

Galv'd Reducing Nipple

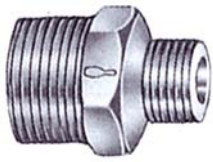

AW00681

Code No.	Size
AW00681	1/2" x 3/8"
AW00682	3/4" x 3/8"
AW00683	3/4" x 1/2"
AW00684	1" x 3/8"
AW00685	1" x 1/2"
AW00686	1" x 3/4"
AW00687	1 1/4" x 3/8"
AW00688	1 1/4" x 1/2"
AW00689	1 1/4" x 1"
AW00690	1 1/2" x 3/8"
AW00691	1 1/2" x 1/2"
AW00692	1 1/2" x 1"
AW00693	1 1/2" x 1 1/4"
AW00694	2" x 3/8"
AW00695	2" x 1/2"
AW00696	2" x 3/4"
AW00697	2" x 1"
AW00698	2" x 1 1/4"
AW00699	2" x 1 1/2"

Galv'd Bush



AW00700

Code No.	Size
AW00700	1/2" x 3/8"
AW00701	3/4" x 3/8"
AW00702	3/4" x 1/2"
AW00703	1" x 3/8"
AW00704	1" x 1/2"
AW00705	1" x 3/4"
AW00706	1 1/4" x 3/8"
AW00707	1 1/4" x 1/2"
AW00708	1 1/4" x 3/4"
AW00709	1 1/4" x 1"
AW00710	1 1/2" x 3/8"
AW00711	1 1/2" x 1/2"
AW00712	1 1/2" x 3/4"
AW00713	1 1/2" x 1"
AW00714	1 1/2" x 1 1/4"
AW00715	2" x 3/8"
AW00716	2" x 1/2"
AW00717	2" x 3/4"
AW00718	2" x 1"
AW00719	2" x 1 1/4"
AW00720	2" x 1 1/2"
AW00721	2 1/2" x 3/8"
AW00722	2 1/2" x 1/2"
AW00723	2 1/2" x 3/4"
AW00724	2 1/2" x 1"
AW00725	2 1/2" x 1 1/4"
AW00726	2 1/2" x 1 1/2"
AW00727	2 1/2" x 2"

High Grade Malleable Iron Pipe Fittings



Plug
AW02382



Flange
AW02402



Flange
AW02392



Plug Cap
AW02412



Cross T
AW02422

General Illustration

Wrought Steel Butt-Welding Fittings (Carbon & Alloy Steel)



90° Elbow (Long)
AW02332



180° Elbow (Long)
AW02342



Reducer (Concentric)
AW02352



Reducer (Concentric)
AW02362



90° Elbow (Short)
AW02372



180° Elbow (Short)
AW00937



Reducer (Eccentric)
AW00947



Reducer (Eccentric)
AW00957

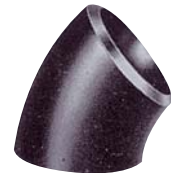

45° Elbow (Long)
AW00967



T (Straight)
AW00977



T (Reducing)
AW00987



Cap
AW00997

Stainless Steel Butt-Welding Fittings



90° Elbow (Long)
AW01007



Reducer (Concentric)
AW01017



T (Straight)
AW01027

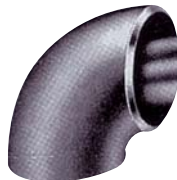

90° Elbow (Long)
AW01037



Reducer (Eccentric)
AW01047

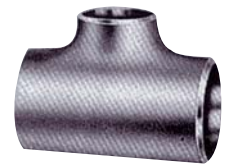

T (Reducing)
AW01057

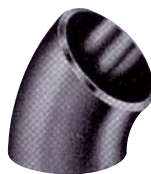

45° Elbow (Long)
AW01067



Lap Joint Stud End
AW01077



Cap
AW01087

Allinton Engineering & Trading Pte Ltd

Head Office: Block 803, King George's Avenue #01-234 Singapore 200803. Tel: 6296 0679 (10 lines) 6292 7728 Fax: 6297 0024

Branch Office: 21 Tuas Basin Link Singapore 638782 Tel: 6265 1888 (10 lines) Fax: 6265 5623

Web-site: <http://www.allinton.com.sg> E-mail: allinton@singnet.com.sg

STEEL, VALVE & PIPE FITTING

Forged Steel Socket-Welding & Threaded

• Socket Welding Fittings				
<p>90° Elbow AW01097</p> 	<p>45° Elbow AW01107</p> 	<p>Tee AW01117</p> 	<p>Cross AW01127</p> 	
<p>Coupling AW01137</p> 	<p>Reducer AW01147</p> 	<p>Cap AW01157</p> 	<p>Union AW01167</p> 	
• Threaded Fittings				
<p>90° Elbow AW01177</p> 	<p>45° Elbow AW01187</p> 	<p>Tee AW01197</p> 	<p>Cross AW01207</p> 	
<p>Coupling AW01217</p> 	<p>Half Coupling AW01227</p> 	<p>Cap AW01237</p> 	<p>Union AW01247</p> 	
<p>Hex Head Plug AW01257</p> 	<p>S.Q. Head Plug AW01267</p> 	<p>Round Head Plug AW01277</p> 	<p>Hex. Head Brushing AW01287</p> 	
<p>Boss AW01297</p> 	<p>Insert AW01307</p> 	<p>Nipple AW01317</p> 	<p>Swage Nipple AW01327</p> 	
• Outlets				
<p>Socket-Outlet AW01337</p> 	<p>Welding-Outlet AW01347</p> 	<p>Thread-Outlet AW01357</p> 	<p>Nipple-Outlet AW01367</p> 	

Allinton Engineering & Trading Pte Ltd

Head Office: Block 803, King George's Avenue #01-234 Singapore 200803. Tel: 6296 0679 (10 lines) 6292 7728 Fax: 6297 0024

Branch Office: 21 Tuas Basin Link Singapore 638782 Tel: 6265 1888 (10 lines) Fax: 6265 5623

Web-site: <http://www.allinton.com.sg> E-mail: allinton@singnet.com.sg