

MATERIAL HANDLING

V-25 Vertical Lifting Clamp



Type N
AQ00548



Type L
AQ00896

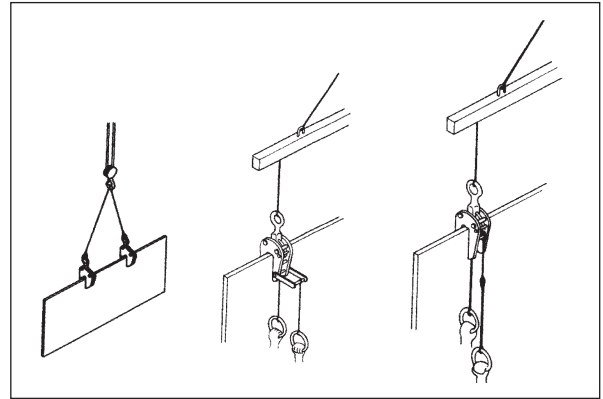

Features

- 1) The heavier the load, the more strongly the load is gripped.
- 2) By simply pushing or pulling the ring, the cam can be either closed or locked in the open position.
- 3) During conveyance, lifting conditions will not change even if the lifted load receives a shock.
- 4) The compression coil spring, with its initial load on the cam, ensures that even the load is delivered and wire loosens, reducing the load to zero, the clamp will not release the load.
- 5) Bolts and nuts are protected by indentations in the main body, which helps reduce wear or potential for damage for use.
- 6) Since the cam can be locked in the open position, clamping from above (vertically) is simplified.
- 7) For lifting operations in high places or with unstable footing, easier operability is obtained by using clamps along with levers or ropes. (Models V-25-K, V-25-L).
- 8) The main body and components are drop forged from special alloy steels as well as heat treated.

Type N Code No.	Type L Code No.	Basic Use Load	Grip Width (min) (max)	A	B	C	D	E	F	G	H	I	J	L	Type N	Type L	Clamp (kg)	D1	D2
AQ00548		1/2 TON	0-16	218	128	40	50	22	20	49	91	30	44	32	○	-	1.6	35	50
AQ00549		3/4 TON	0-16	279	162	50	74	36	22	66	124	56	68	49	○	-	4.5	50	65
AQ00550	AQ00896	1 TON	0-25	355	205	60	78	33	32	76	141	56	68	49	○	○	5.8	60	90
AQ00551	AQ00897	2 TON	0-30	320	224	65	82	38	36	78	152	58	70	52	○	○	6.9	60	95
AQ00552	AQ00898	3 TON	0-38	425	257	75	95	46	43	90	179	66	80	57	○	○	10.5	70	115
AQ00553	AQ00899	5 TON	0-40	452	275	75	105	50	50	105	205	78	116	73	○	-	15.5	70	110
			0-50	579	342	90	122	60	60	133	253	86	122	82	○	○	22.0	85	150
AQ00554		10 TON	0-50	660	410	100	152	80	70	157	307	105	145	102	○	○	46.0	115	180
			0-75		715	410		162		90	160	330	145	112	○	○	53.0	115	190

Clamp naming style: (example) Model V-25-N-5-ton (0-40)

V-25EL Steel Plate Vertical Clamp



(Light weight Model)
AQ00555

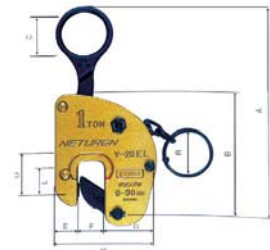

Features

- 1) The main body and components are made from special alloy steel.
- 2) Precision drop forging produces a lightweight and compact product.
- 3) Powerful cam: increases in the lifting load result in a proportionally stronger grip on the load.
- 4) Locking lever with ring: with lever ring locking, the compression coil spring applies a minimum initial load to the cam so that the clamp does not release the load, even when the load falls to zero and the wire loosens as the load is delivered.
- 5) Electrodeposited coating: the main unit has a two-layer surface treatment, for better anti-rust protection.
- 6) Teflon coating: the internal interchangeable component has superior anti-adhesion, anti-corrosion, anti-wetting, and wear resistance characteristics.

Specifications

Code No.	Basic Use Load	Grip Width (min) (max)	A	B	C	D	E	F	G	H	I	J	K	L	M	R	Clampweight (kg)
AQ00555	1 TON	0-30	300	177	55	60	30	35	68	133	28	52	13	40	27	57	3.5
AQ03665	2 TON	0-30	326	195	58	68	36	35	75	146	32	59	14	43	34	57	4.9
AQ00556	3 TON	0-40	364	221	64	33	45	46	94	185	54	70	18	55	32	65	8.3

Clamp naming style: (example) Model V-25 EL 1-ton (0-30)

Allinton Engineering & Trading Pte Ltd

Head Office: Block 803, King George's Avenue #01-234 Singapore 200803. Tel: 6296 0679 (10 lines) 6292 7728 Fax: 6297 0024

Branch Office: 21 Tuas Basin Link Singapore 638782 Tel: 6265 1888 (10 lines) Fax: 6265 5623

Web-site: <http://www.allinton.com.sg> E-mail: allinton@singnet.com.sg

NETSUREN

MATERIAL HANDLING

FL-VA Flawless Vertical Lifting Clamp



AQ00557

Dimensions

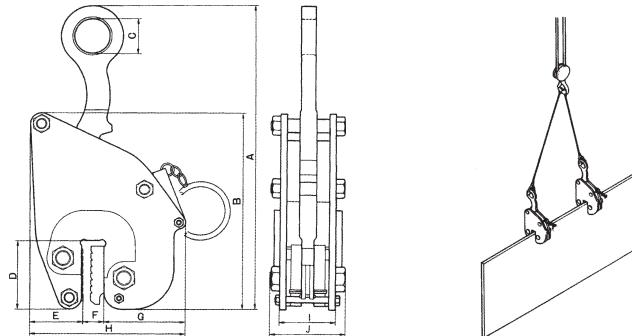

Specifications

Code No.	Basic Use Load	Grip Width (min) (max)	Clamp Weight (kg)	Dimensions											
				A	B	C	D	E	F	G	H	I	J		
AQ00557	1/2 TON	3-13	5.0	340	195	40	75	50	15	90	157	48	70		
AQ00558	1 TON	3-15	6.5	385	215	50	85	60	17	102	181	60	90		
AQ00559	2 TON	6-25	13.5	495	290	60	105	70	26	123	221	68	120		
		6-30	14.5	495	320	60	105	70	31	126	227	68	120		
AQ00560	3 TON	8-32	20.5	515	339	56	119	88	34	134	256	78	108		

Clamp naming style: (example) Model FL-VA 2-Ton

Features

- 1) Clamp strength increases proportionally to increases in the load, powerfully gripping the load.
- 2) The clamp can be clamped on the load with the locking lever in the open position and then subsequently locked.
- 3) If sliding or overload occurs, an internal toothed safety cam clamps onto the load to prevent sliding.
- 4) Clamps are extra tough due to special alloy steel and advanced manufacturing and heat treatment.

FL-V Flawless Vertical Clamp

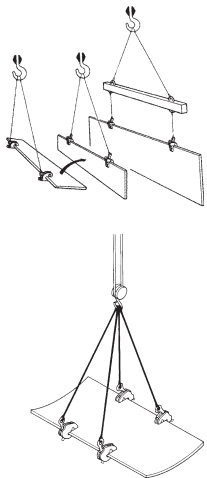

Dimensions

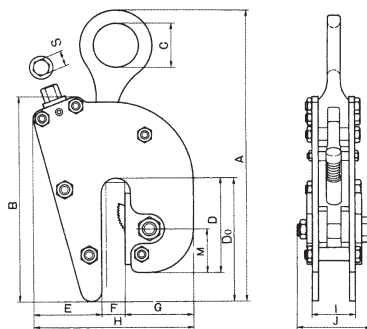

AQ00561

Features

- 1) Netsuren Model FL-V clamp lifts heavy loads without scratching, a task previously believed impossible. It is an epoch-making clamp developed with safety foremost in mind.
- 2) The many uses for this clamp include lifting standard steel plates, high-tension steel plates for bridges, boiler manufacture or manufactured plates, high-pressure tanks, and others. It is also appropriate for stainless steel plates, aluminium plates, and other non-ferrous plates where magnets cannot be used for lifting operations.
- 3) Clamping takes place between the light alloy slider, which adjusts to the thickness of the load, and the grip plate with its special mechanism, to ensure that "sliding" does not occur.
- 4) The clamp contains a failsafe mechanism to prevent dropping from sliding caused by overload or shocks from hitting obstacles.

Specifications

Code No.	Basic Use Load	Grip Width (min) (max)	Clamp Weight (kg)	Dimensions												
				A	B	C	D	Do	E	F	G	H	I	J	M	
AQ00561	1/2 TON	0-16	3.0	19	245	149	40	72	82	59	19	60	138	44	74	40
AQ00562	1 TON	0-25	7.5	19	400	233	60	113	148	71	29	79	179	52	80	55
AQ00563	2 TON	0-25	10.5	19	430	282	60	130	170	92	32	93	217	58	98	60
AQ00564	3 TON	0-30	18.0	19	520	303	75	135	183	107	36	97	240	70	118	62
		20-50	19.0									56		250		
AQ00565	5 TON	0-30	32.0	22	610	380	90	165	225	115	40	130	295	99	154	90
		20-50	32.9									60		310		

Clamp naming style: (example) Model FL-V 3-Ton (0-30)

Allinton Engineering & Trading Pte Ltd

Head Office: Block 803, King George's Avenue #01-234 Singapore 200803. Tel: 6296 0679 (10 lines) 6292 7728 Fax: 6297 0024

Branch Office: 21 Tuas Basin Link Singapore 638782 Tel: 6265 1888 (10 lines) Fax: 6265 5623

Web-site: <http://www.allinton.com.sg> E-mail: allinton@singnet.com.sg

NETSUREN

MATERIAL HANDLING

Easy Horizontal Lifting Clamp

DANGER:

- 1) Lifting methods F, G and H shown at right are dangerous with the Easy Clamp. Absolutely do not use them. (For methods F and G in particular, the clamp grip will be weak because the cam pivot bolt and the ring align vertically.)
- 2) Lifting method H is strictly prohibited.



TYPE O
AQ00566

TYPE S
AQ03666

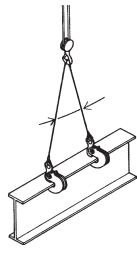

Less than 25°

F	G	H
1-2 point lift (hook lift)	Balance lifting (steel plate flat lift)	2-point angle lift (section steel flat lift)

Dimensions

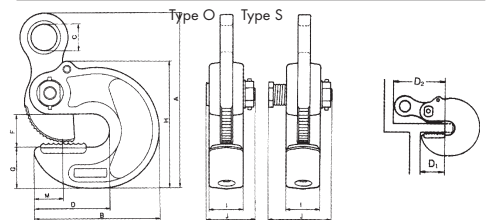

Features

- 1) The Easy clamp provides highly efficient lifting for such steel sections as angles, channels, and I-beams.
- 2) The cam grips more powerfully in response to increasing loads.
- 3) The grip plate is R-shaped so that, when lifting at an angle, the torsion force on the main body is low, ensuring smooth operations.
- 4) A torsion coil spring is installed on the cam pivot bolt of the Type S, thus when attaching the clamp, it is not necessary to hold it by hand. Once a load has been clamped, upon arrival the clamp does not release the load, even when the load falls to zero and the wire loosens as the load is delivered.

Specifications

Code No.	Basic Use Load	Grip Width (min) (max)	Type	D1	D2	A	B	C	D	F	G	H	I	J	M	Clamp Weight
AQ00566	1 TON	0-16	○ S	50	102	156	124	24	68	24	37	114	30	48 65	26	2.4 2.5
AQ03666	2 TON	0-20	○ S	65	135	201	152	30	89	38	48	147	40	55 73	3.4	4.1 4.2
		16-28	○ S						34					55 73		4.1 4.2
AQ00568	3 TON	10-40	○ S	72	170	232	181	36	98	60	65	167	45	60 88	4.0	7.7 7.8
		25-45	○ S	72	155									60 88		7.4 7.5

Clamp naming style: (example) Easy clamp 1-Ton (Model 16-S) (example) Easy clamp component 2-Ton (Model 20-S) cam

HA-110 Horizontal Lifting Clamp



AQ00569

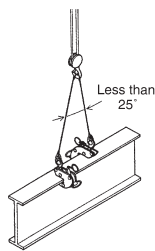

Less than 25°

Features

- 1) Exclusively for H-beams, L-beams, and similar steel sections.
- 2) As a horizontal lifting clamp, stable horizontal lifting operations are made possible.
- 3) Since the lower part of the main unit is split, the clamp can be attached widthwise to both sides of beams, making it especially useful for H-beams.
- 4) The clamp can be attached and released by means of a locking ring. To make this operation easier, a grip is attached to the back of the main unit.
- 5) Drop forged from special alloy steel, this clamp is lightweight and compact, making it easy to operate.

Specifications

Code No.	Basic Use Load	Grip Width (min) (max)	Clamp Weight (kg)
AQ00569	1 TON	0-25	3.8
AQ00570	2 TON	0-30	5.5
AQ00571	3 TON	0-40	11.0
AQ00572	5 TON	0-50	23.0

Clamp naming Style: (example) Model HV-G 2-Ton

HV-G Vertical/Horizontal Combined Use Clamp



AQ00573

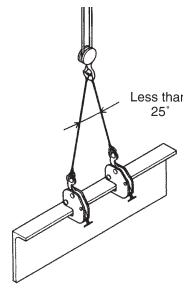

Less than 25°

Features

- 1) Suitable for lifting and flipping steel sections such as angles, channels, and I-beams.
- Uses
- suitable for lifting and flipping structural steel sections such as I-forms, T-forms, angles, channels, etc.
 - Especially suitable for lifting objects with narrow face width.

Specifications

Code No.	Basic Use Load	Grip Width (min) (max)	Clamp Weight (kg)
AQ00573	1/2 TON	0-20	2.0
AQ00574	2 TON	0-25	4.0
AQ00575	3 TON	0-30	7.3
AQ00576	5 TON	0-40	12.0

Clamp naming Style: (example) Model HV-G 2-Ton

CH-N Horizontal Lifting Clamp



AQ00577

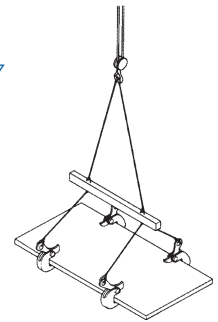

Features

- 1) This clamp is exclusively for horizontal lifting and stacking of steel plates.
- 2) There is no danger of slippage, because the cam works harder to adjust gripping force in response to the lift load.
- 3) The torsion coil spring on the cam pivot bolt applies an initial load, resulting in more stable attachment of the clamp before lifting.

Specifications

Code No.	Basic Use Load	Grip Width (min) (max)	Clamp Weight (kg)
AQ00577	1/2 TON	0-20 15-35	1.2 1.4
AQ00578	1 TON	0-25 20-45	1.8 2.0
AQ00579	2 TON	0-30 25-55	4.6 4.8
AQ00580	3 TON	0-40 35-75	9.5 10.0
AQ00581	5 TON	0-50 45-95	25.0 26.0

Clamp naming Style: (example) Model CH-NF 2-Ton (0-30)